

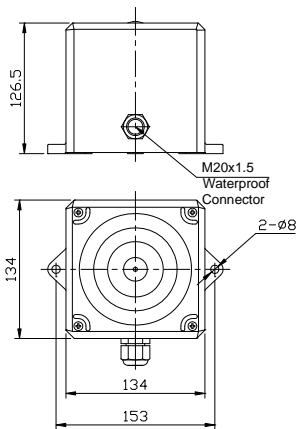

Mounting dimension (Unit:mm)



Wiring diagram

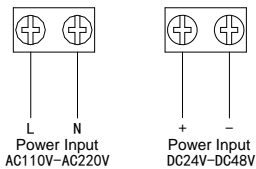

Figure 1

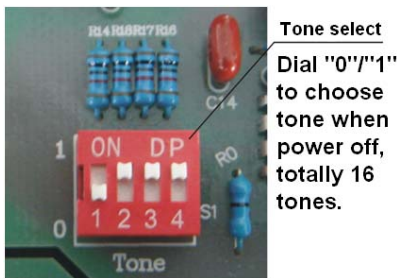

Figure2

Application



Applications

Specially design for all kinds of harbors machinery, electrical and mechanical industry, large and medium-sized vehicle and ship, dock equipment.

Main Functions and features

- Various tones available for selection.
- Ease of using, can work long hours.
- Specific integrated chip design, Good anti-RF.
- Good structural design, ease of operation.
- ABS housing, anti-UV, anti-aging ingredients, salt corrosion resistance, Unique design ensure waterproof, moisture resistance, and shookproof functions.

Specifications:

Operating voltage	AC110V~AC240V/DC24V (optional)	Frequency	50Hz~60Hz
Tone	various (optional)	Power	8W
Horn impedance	8Ω	Sound level	108dB
Operating temperature:	-30℃ ~ +70℃	IP Protection	IP66
Relative humidity	10% ~ 95% (no condensing)	Weight	0.8Kg
Material	Main body: ABS		

Installation and Operation

- Check whether the operating voltage complies with the rated voltage of the siren
- Secure the alarm body on a smooth surface with enough mechanical strength using M6 stainless steel screws. Mounting surface should be in a line with the axes of lamp body
- Follow the wiring diagram of Figure I. connect the power line, check before turning on the power switch.
- turn off the power supply before adjust the alarm tone, toggle circuit board in the DIP switch to select tone.
- Select the tone, please note that cut off the power first, then DIP switch encoded by the binary encoding selected tone, totally 16 tones (see wiring diagram figure II).

Select table

Model	Tone
AE001	Multi-tone
AE002	Single-tone

Notice

- The part of material of products is PC(like lamp cover and lamp shell), so it cannot direct or indirect touch the organic solvent, such as industrial alcohol, banana oil, isopropyl alcohol, carbon tetrachloride, cyclohexanone and so on, otherwise, the product will be corrosion.
- This product can be used in indoor, outdoor and ship, Please read the instruction manual carefully before operation.
- control box warming is normal.
- Do not install the bell facing up to avoid accumulation of water.
- Do not open the case. Any questions, please contact us.